

Central Tent * Commercial Frame Tent * Quality Frame Tent * Central Tent * Commercial Frame Tent * Central Tent * Commercial Frame Tent * Central Tent * Commercial Frame Tent * Quality Frame Tent * Central Tent * Commercial Frame Tent * Central Tent * Commercial Frame Tent * Quality Frame Tent * Central Tent * Commercial Frame Tent * Central Tent * Commercial Frame Tent

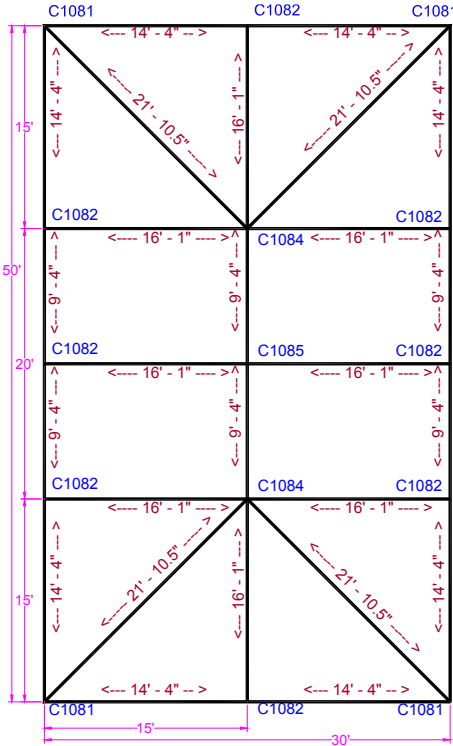

| 30x50 Standard Double Tube Frame Tent (10 Ft. Leg Span) | | | |
|---|---------------------------------------|--------------|-------|
| FITTINGS | | Part # | |
| Qty | | | |
| 4 | Corner - Double Tube | C1081 | |
| 8 | Side Tee Joint | C1082 | |
| 2 | 6 Way Crown | C1084 | |
| 1 | Ridge Top Tee | C1085 | |
| 3 | Cables 30 Ft. | CB30X | |
| 76 | Canopy Pins (3 in.) | A03 | |
| Qty | Size | D-Tube Poles | Color |
| 8 | 14'-4" | Spreader | Red |
| 4 | 21'-10" | Hip Rafter | Red |
| 8 | 16'-1" | Rafter | Red |
| 6 | 9'-4" | Top Spreader | White |
| 12 | 7'-8" | Legs | Black |
| Qty | Accessories | | |
| 12 | Base Plates | | |
| 4 | Corner Leg Braces for Double Tube | | |
| 8 | Tee Leg Braces for Double Tube | | |
| 16 | Ratchet Ropes and Stakes (12 Minimum) | | |
| 160 | Feet of Perimeter Sidewall | | |
| Options | | | |
| Expandable 3-4 Pcs. | | | |
| Colors (Solid or stripes) | | | |
| Clear 20 Ga. | | | |
| Notes | | | |

Central Tent * Commercial Frame Tent * Quality Frame Tent * Central Tent * Commercial Frame Tent * Central Tent * Commercial Frame Tent * Quality Frame Tent * Central Tent * Commercial Frame Tent * Central Tent * Commercial Frame Tent * Quality Frame Tent * Central Tent * Commercial Frame Tent

